

## Sommario

- Scheda 1: correzione ponti termici nicchie radiatori, cordoli, pilastri strutturali, piastre in marmo
- Scheda 2: correzione ponti termici terrazze
- Scheda 3: muratura perimetrale con cappotto esterno e placcaggio interno
- Scheda 4: muratura perimetrale con cappotto esterno e controparete interna
- Scheda 5: bonifica tetto in legno
- Scheda 6: massetto a secco a basso spessore con integrato riscaldamento radiante



**AEROPAN**  
composites

Design - Engineering &  
High performance thermoplastic composite  
materials for automotive,  
Building & Construction, Off-Highway and  
Industrial Applications

**MICHELE NONIS**

TECNICO COMMERCIALE

Mobile: +39 347 4346718  
E-mail: [michelelonis1@gmail.com](mailto:michelelonis1@gmail.com)

**A.m.a Composites s.r.l.**  
Via Repubblica, 7  
41011 Campogalliano  
Modena - Italy  
Tel +39 059 851754  
Fax +39 059 522116  
[www.amacomposites.it](http://www.amacomposites.it)  
[www.aeropan.it](http://www.aeropan.it)

CORREZIONE PONTI TERMICI

- NICCHIE RADIATORI
- CORDOLI E PILASTRI STRUTTURALI
- PIANE E FINESTRE

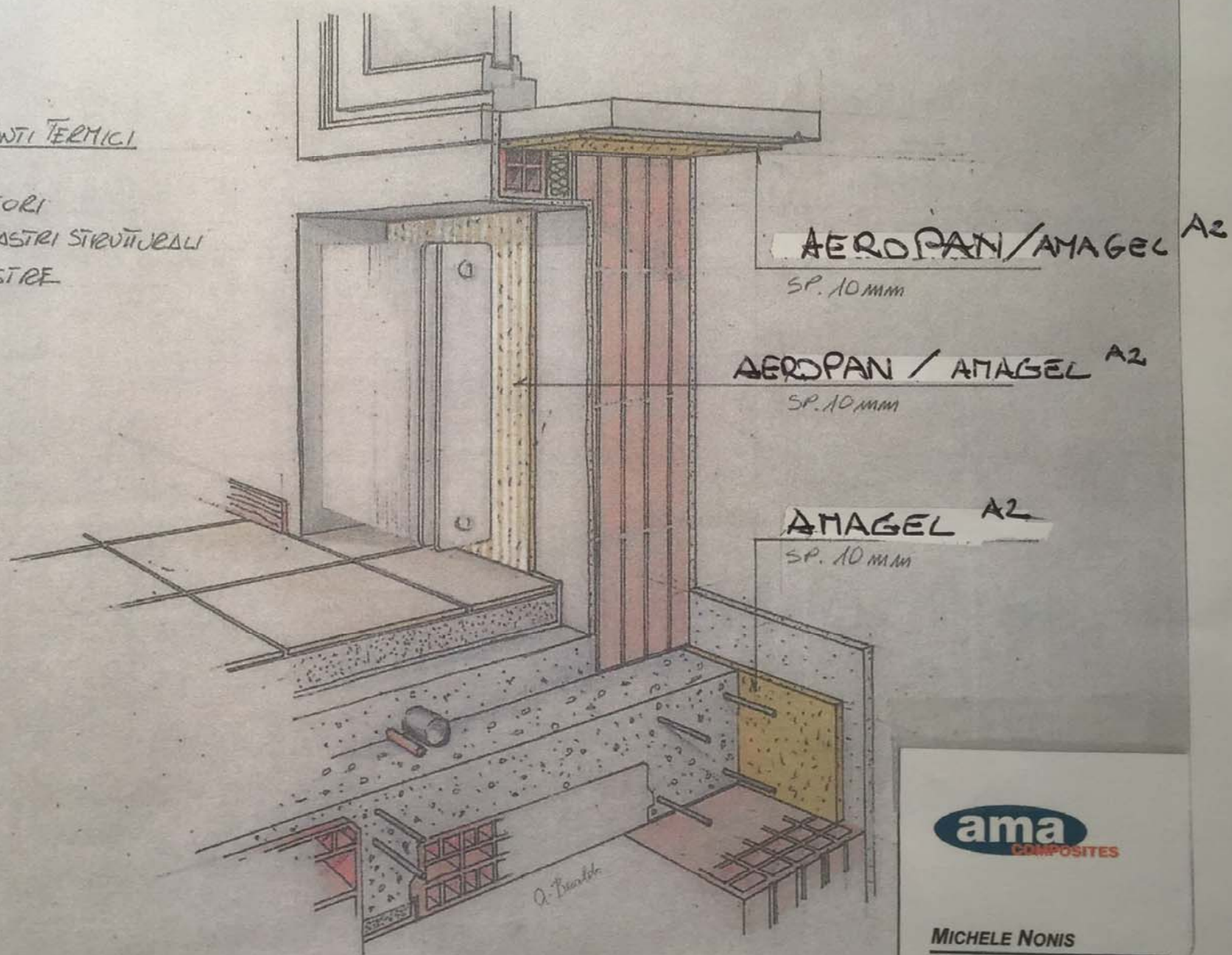

**MICHELE NONIS**

TECNICO COMMERCIALE

Mobile: +39 347 4346716  
E-mail: michelenonis1@gmail.com



CORREZIONE PONTI TERMICI TERRAZZE

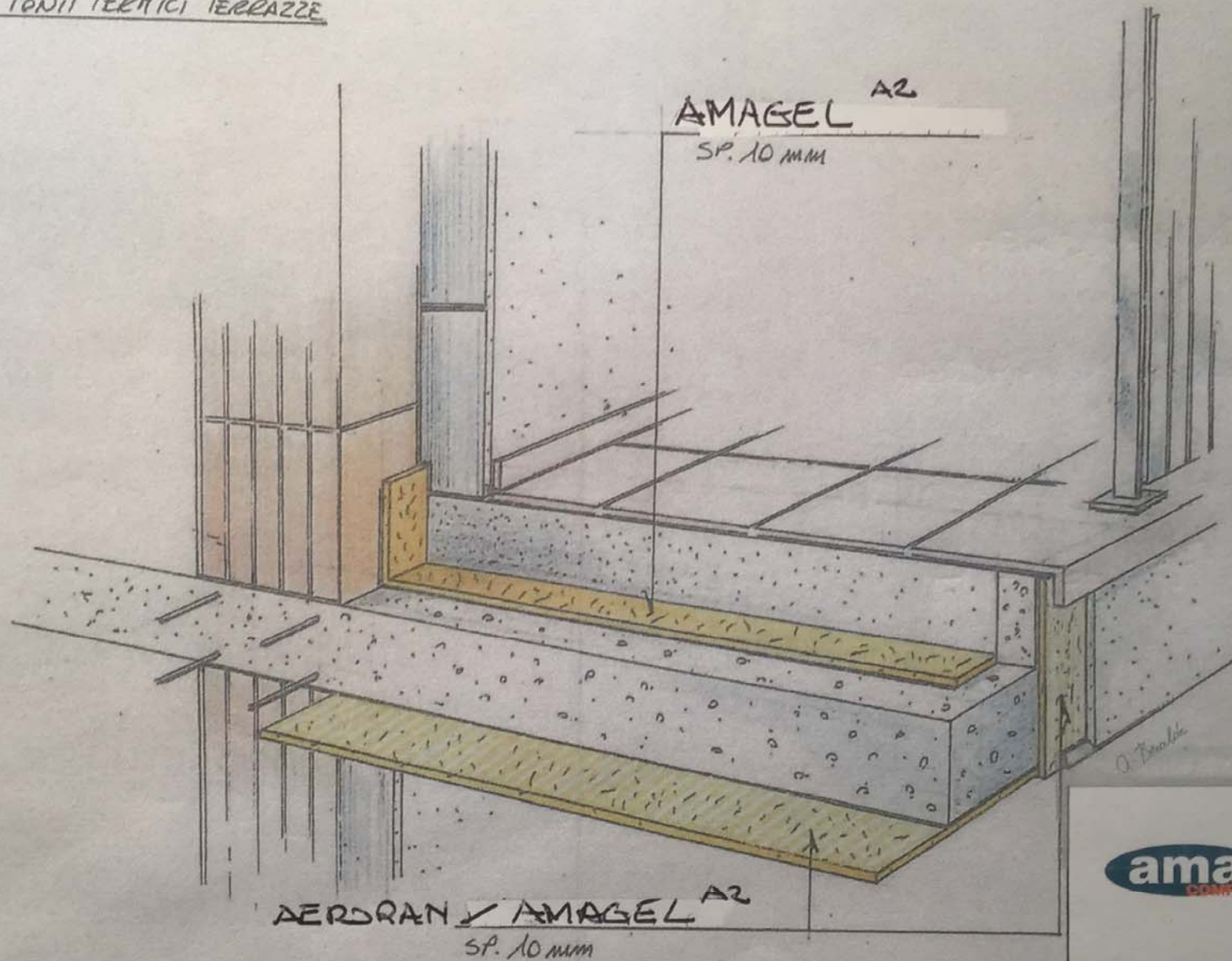

**MICHELE NONIS**  
TECNICO COMMERCIALE

Mobile: +39 347 4346716  
E-mail: michelenonis1@gmail.com

SITUAZIONE DI PARTENZA

TRASMITTANZA  $U = 1,877 \text{ W/m}^2\text{K}$

SFASAMENTO = 3,57 h

SITUAZIONE POSTBONIFICA

TRASMITTANZA  $U = 0,469 \text{ W/m}^2\text{K}$

SFASAMENTO = 7,66 h

**AEROPAN**

SP. 10 mm

RASATURA ARITATA

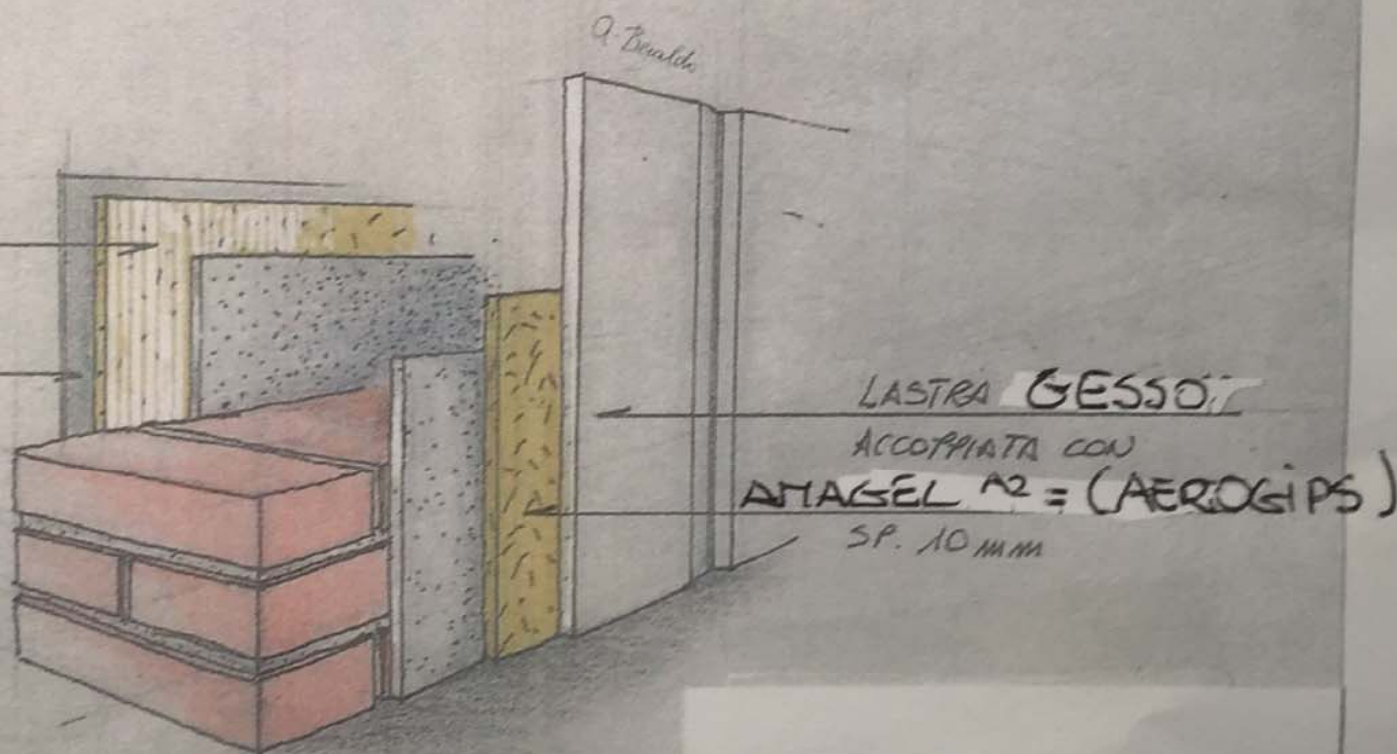

**AEROPAN**

Design - Engineering &  
High performance thermogellic composite  
materials for automotive,  
Building & Construction, Oil/Highway and  
Industrial Applications

**MICHELE NONIS**

TECNICO COMMERCIALE

Mobile: +39 347 4348716  
E-mail: michelenonis1@gmail.com

A.m.a Composites s.r.l.  
Via Repubblica, 7  
41011 Campogalliano  
Modena - Italy  
Tel +39 059 851754  
Fax +39 059 522116  
www.amacomposites.it  
www.aeropan.it



SITUAZIONE DI PARTENZA

TRASMITTANZA  $U = 1,877 \text{ W/m}^2\text{K}$

SFASAMENTO = 3,57 h

SITUAZIONE POST BONIFICA

TRASMITTANZA  $U = 0,328 \text{ W/m}^2\text{K}$

SFASAMENTO = 8,19 h

**AEROPAN**

SP. 10mm

RASATURA ARATA

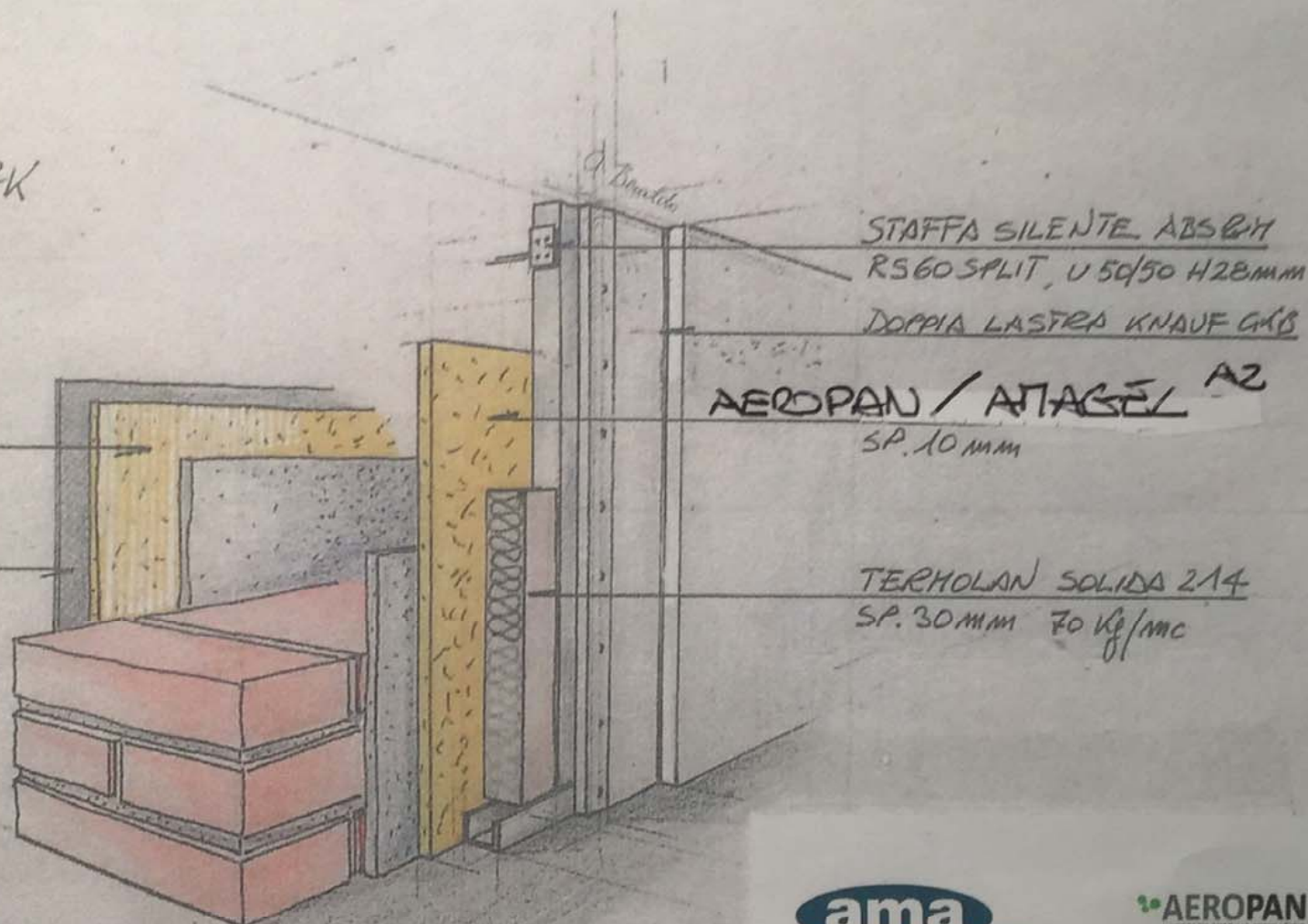

STAFFA SILENTE ABS 6/11  
RS60 SPLIT, U 50/50 H28mm

DOPPIA LASTRA KNAUF GAB

AEROPAN / ATAGEL AZ  
SP. 10mm

TERHOLAN SOLIDA 214  
SP. 30mm 70 kg/mc



**AEROPAN**  
NANOTECH THERMAL INSULATION  
Design - Engineering &  
High performance thermoplastic composite  
materials for automotive,  
Building & Construction, Off-Highway and  
Industrial Applications

**MICHELE NONIS**  
TECNICO COMMERCIALE

Mobile: +39 347 4346716  
E-mail: michelenonis1@gmail.com

A.m.a Composites s.r.l.  
Via Repubblica, 7  
41011 Campogalliano  
Modena - Italy  
Tel +39 059 851754  
Fax +39 059 522116  
[www.amacomposites.it](http://www.amacomposites.it)  
[www.aeropan.it](http://www.aeropan.it)

SITUAZIONE DI PARTENZA

TRASMITTANZA  $V = 0,543 \text{ W/m}^2\text{K}$

SFASAMENTO = 1,66 h

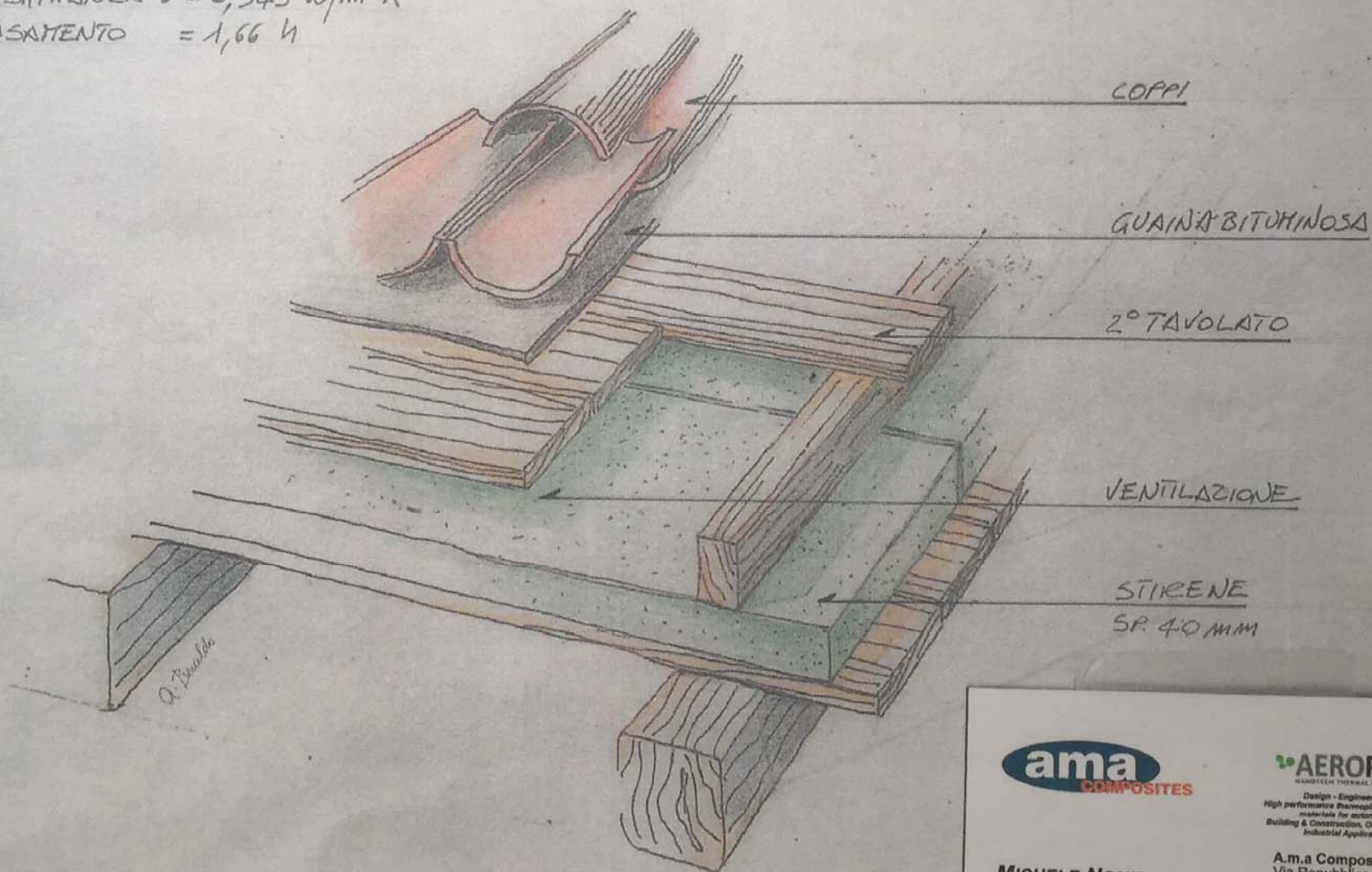

Design - Engineering &  
High performance thermoplastic composite  
materials for automotive,  
Building & Construction, Off-Highway and  
Industrial Applications

**MICHELE NONIS**

TECNICO COMMERCIALE

Mobile: +39 347 4346716  
E-mail: michelenonis1@gmail.com

A.m.a Composites s.r.l.  
Via Repubblica, 7  
41011 Campogalliano  
Modena - Italy  
Tel +39 059 851754  
Fax +39 059 522116  
[www.amacomposites.it](http://www.amacomposites.it)  
[www.aeropan.it](http://www.aeropan.it)



SITUAZIONE POST BONIFICA

TRASMITTANZA  $U = 0,268 \text{ W/m}^2\text{K}$

SFASAMENTO = 3,67 h

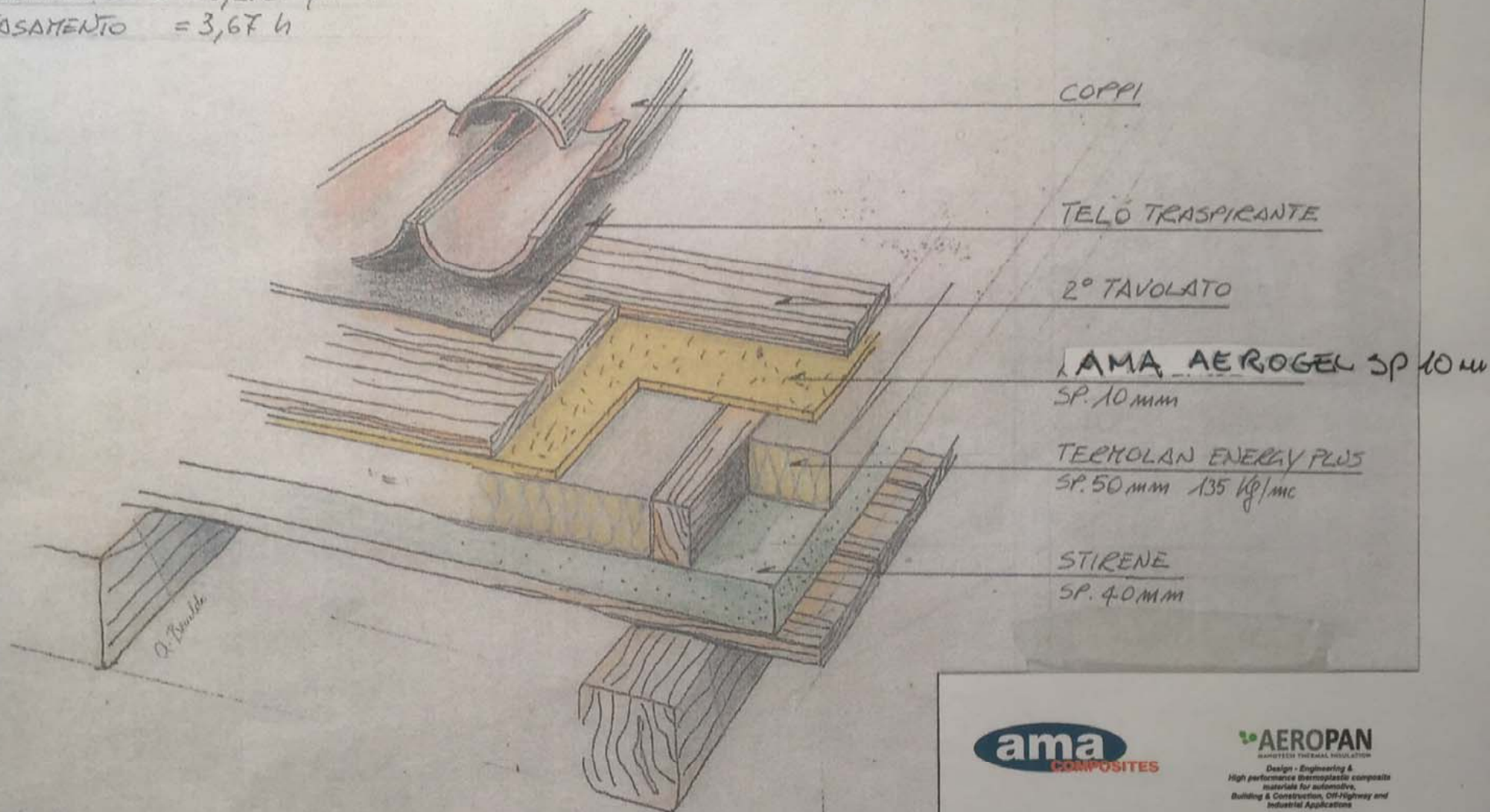

**AEROPAN**  
REINFORCED THERMAL INSULATION  
Design - Engineering &  
High performance thermoplastic composite  
materials for automotive,  
Building & Construction, Off-Highway and  
Industrial Applications

**MICHELE NONIS**  
TECNICO COMMERCIALE

Mobile: +39 347 4346716  
E-mail: michelelonis1@gmail.com

A.m.a Composites s.r.l.  
Via Repubblica, 7  
41011 Campogalliano  
Modena - Italy  
Tel +39 059 851754  
Fax +39 059 522116  
[www.amacomposites.it](http://www.amacomposites.it)  
[www.aeropan.it](http://www.aeropan.it)

# BONIFICA SOLAIO

SOLUZIONE INTEGRATA A BASSO SPAESORE

PAVIMENTO DI FINITURA

KNAUF GIFAFLOR SP. 25 mm

EUROTHECH ZERO MAX

AMA AEROGEL SP. 10 mm

SITUAZIONE PRE ESISTENTE

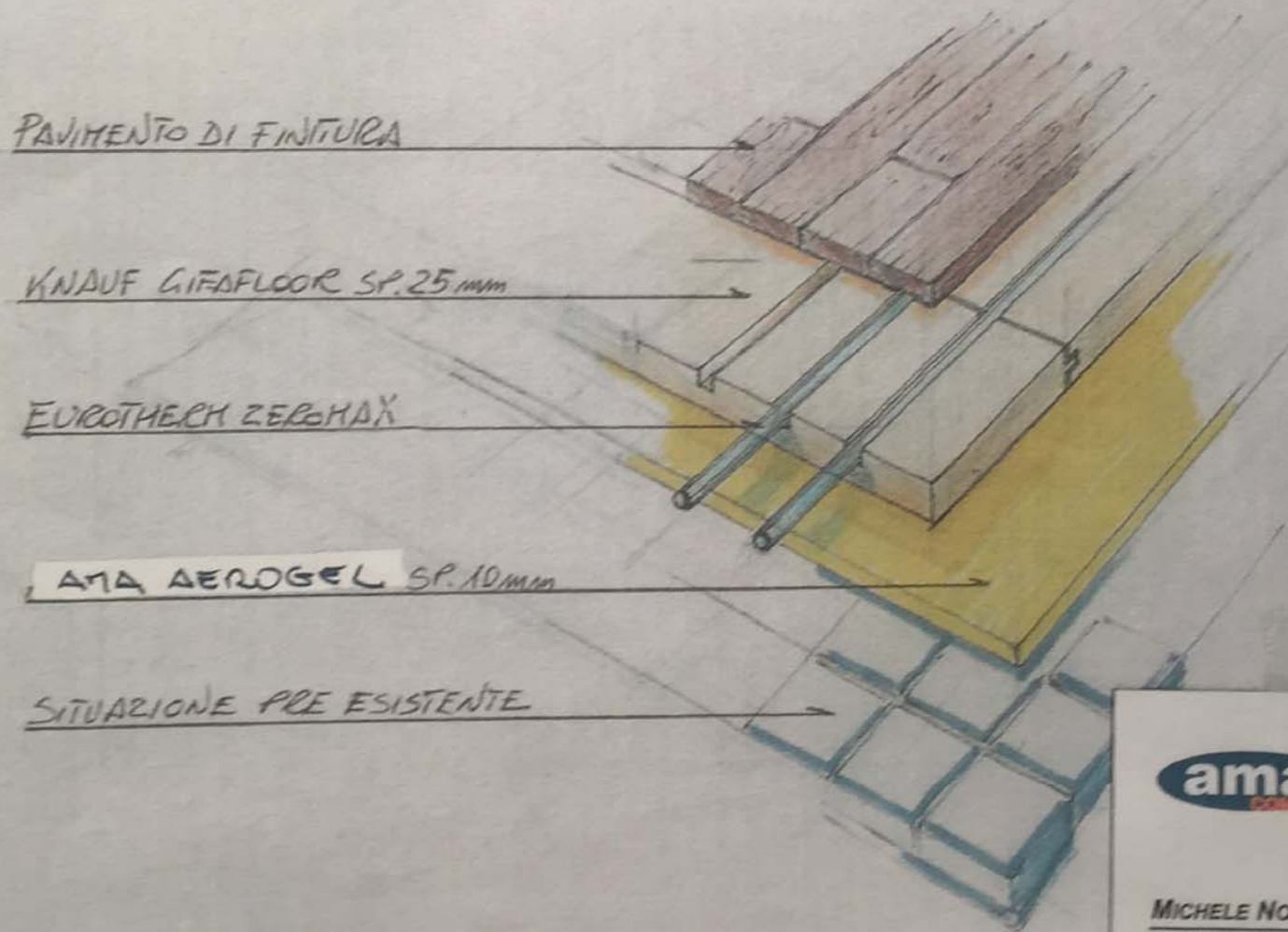

**AEROPAN**  
AEROGEL - INSULATION - PROTECTIVE

Design - Engineering &  
High performance thermoplastic composite  
materials for automotive,  
Building & Construction, Oil & Gas and  
Industrial Applications

**MICHELE NONIS**

TECNICO COMMERCIALE

Mobile: +39 347 4345718  
E-mail: michelenonis1@gmail.com

A.m.a Composites s.r.l.  
Via Repubblica, 7  
41011 Campogalliano  
Modena - Italy  
Tel +39 059 851734  
Fax +39 059 522118  
www.amacomposites.it  
www.aeropan.it